

versatile™ 4C Surface Mount Collar, SM15D

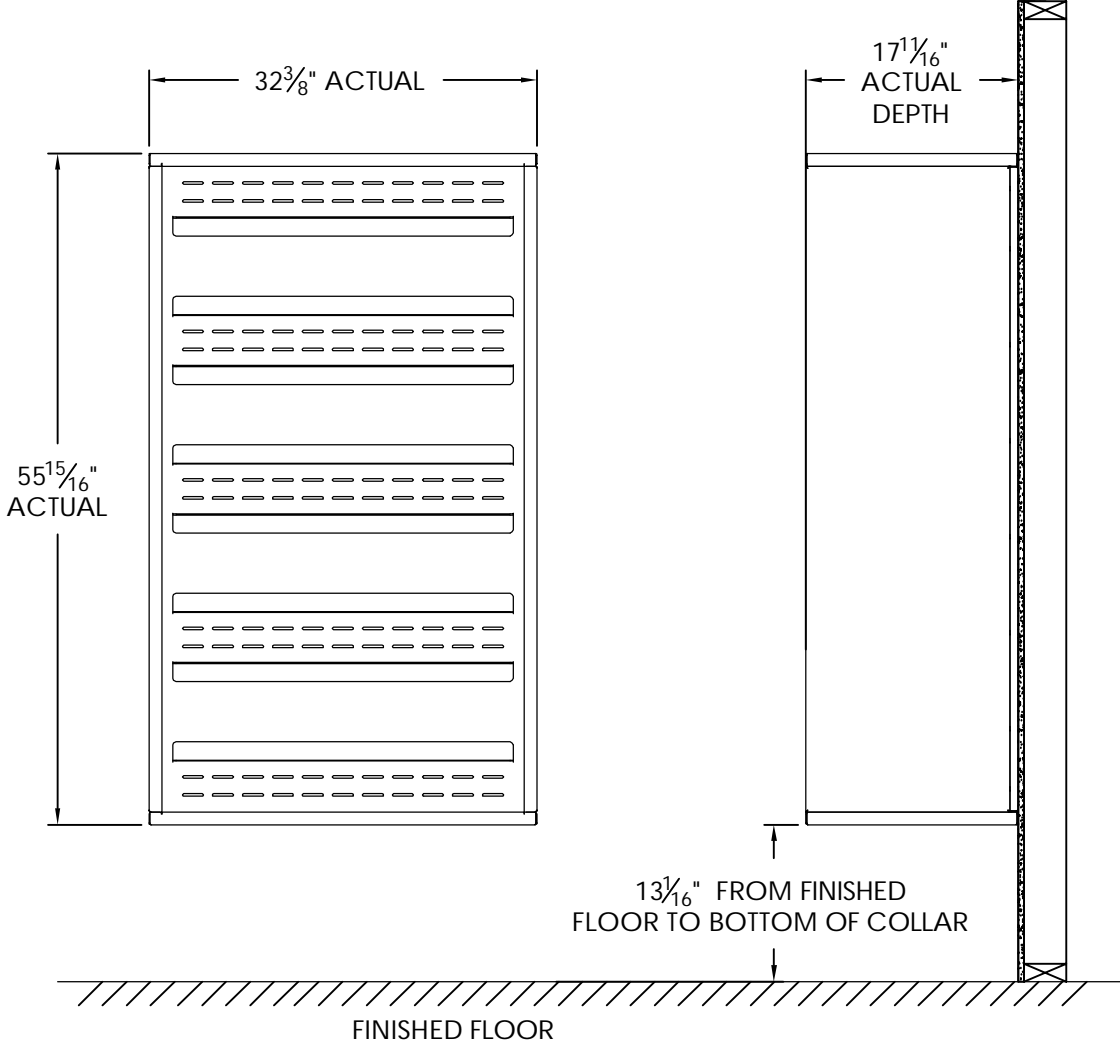

- Notes:
- 1. Designed to mount Florence Versatile™ 4C mailbox double column 15-High Suite modules (sold separately).
 - 2. For use with front loading modules only.

PRODUCT SERIES: VERSATILE™ 4C SURFACE MOUNT COLLAR

| | | | |
|----------------|---------|---------------|------------|
| MODEL | SM15D | REV | B |
| SCALE | NONE | LAST REV DATE | 07/02/2014 |
| DRAWING NUMBER | SM15DCS | DRAWN BY | TNS |